



## SPEC SHEET

## Tray Stand



## Specifications

Top is 16 gauge 304 stainless steel #4 finish. Front and back edges are turned down 102° and turned back 90° eliminating the gap between the top and the base of the cabinet. The ends are turned down 90° flush with cabinet base, this eliminates any open space between G.A. Systems cabinets. The top is secured to the base with 4 stainless steel flush head screws. One 3/4" diameter pin is welded at one end of the top. The pin has two 5/16" diameter holes. The lower hole is used to join adjacent G.A. Systems cabinets. Cut out in top holds one 12" x 20" food pan.

Body of cabinet is fabricated of 1" square 18 gauge stainless steel and cold rolled tubing to form the top and bottom frames. Each is welded to 1-1/2" square 18 gauge stainless steel corner posts. Each corner post is capped. All joints are welded with all exposed welds being ground and polished. 20 gauge galvanized body panels are welded to tubing super structure.

Exterior front, back and one end are trimmed with 22 gauge stainless steel #4 finish trim to accept laminated color panels. Laminate is applied to 1/8" board for additional strength.

Bottom is fully enclosed. There is a 3-3/4" clearance from the bottom of the cabinet to the floor. Plate type 3" swivel non-marking casters with brakes. Cabinet heights are ADA compliant.

## Dimensions

ITEM	MODEL	LENGTH	WIDTH	HEIGHT	F
C1143	TC30	38"	30-3/8"	34"	20"
C1144	TC36	38"	36-3/8"	34"	20"
C1141	ETC30	38"	30-3/8"	31-1/2"	17-1/2"
C1142	ETC36	38"	36-3/8"	31-1/2"	17-1/2"

PROJECT: \_\_\_\_\_

ITEM #: \_\_\_\_\_

MODEL: \_\_\_\_\_

## Standard Features

- ☐ Locking pin, 1
- ☐ 12" x 20" cut out on top shelf
- ☐ Plate type 3" swivel non-marking casters with brakes

## Options

- ☐ No Pin
- ☐ No cut out

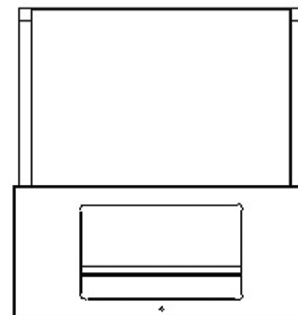

TOP VIEW

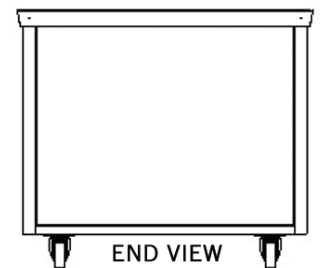

END VIEW

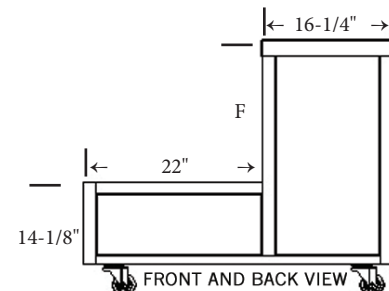

FRONT AND BACK VIEW